



LICENSING (HEARING) SUB COMMITTEE

Date: WEDNESDAY, 16 JULY 2014

Time: 10.00 am

**Venue: COMMITTEE ROOM - 2ND FLOOR
WEST WING, GUILDHALL**

**APPLICANT:
OLIVE GRILL LTD**

**PREMISES:
BADOLINA, 210 BISHOPSGATE, EC2M
4NR**

CONTENTS

Contents

Hearing Procedure	(Pages 1 - 2)
Report of the Director of Markets & Consumer Protection	(Pages 3 - 8)
Appendix 1: Copy of Application	(Pages 9 - 24)
Appendix 2: Conditions consistent with the operating schedule	(Pages 25 - 26)
Appendix 3: Representations from responsible authorities	(Pages 27 - 28)
Appendix 4: Representations from other persons	
i) Adele Nakchbandi	(Pages 29 - 30)
ii) Norma Nakchbandi	(Pages 31 - 32)
iii) Daniel Bell	(Pages 33 - 34)
Appendix 5: Map of subject premises together with other licensed premises in the area and their latest terminal time for alcohol sales	(Pages 35 - 36)
Appendix 6: Plan of Premises	(Pages 37 - 38)

LICENSING (HEARING) SUB COMMITTEE PROCEDURE FOR PUBLIC HEARINGS

1. This procedure shall apply to all public hearings conducted under the provisions of the Licensing Act 2003.
2. Public hearings conducted under the provisions of the Licensing Act 2003 shall take the form of a discussion led by the licensing authority. Cross-examination will be permitted when the Sub Committee considers it to be required. The conduct of hearings shall be broadly based, subject to the discretion of the Sub Committee, on the points set out below.
3. At the start of the hearing the Chairman of the Sub Committee will introduce him/herself and other Members of the Sub Committee as well as the City Corporation officers present. Anyone making representations will then be asked to introduce themselves and anyone accompanying them. The applicant will then do likewise.¹
4. The Chairman will then explain the purpose of the hearing and the procedure to be followed at the hearing. The Sub Committee will then make any rulings necessary in respect of requests for witnesses to be heard in support of any of the parties making representations or the applicant.
5. Those making representations will then be invited to present their case. Repetition will not be permitted. Equal time will be offered to the applicant and those making representations. Where there is more than one party making representations and/or calling witnesses in support, consideration should be given to having one spokesman on behalf of all parties so as to avoid repetition. Although the use of a spokesman will be encouraged by the Sub Committee, the decision rests with those parties making representations.
6. In the event of disorder or persistent disregard of the authority of the Chair, the Chairman may suspend or adjourn the hearing, or require that the person(s) causing disorder or showing disregard leave the hearing.
7. In the event that the Sub Committee has decided that cross-examination will be permitted, the applicant will be invited to ask questions of the party(s) making representations and their witnesses (if any). The party(s) making representations and any witnesses giving evidence in support will then answer any questions put to them by members of the Sub Committee.
8. The applicant will then be invited to present their case and call any witnesses in support of their application. The applicant will be entitled to the same period of time to present his case as those making representations were afforded.

¹ In hearings where a licence is being reviewed, references in this procedure to ‘applicant’ should be read as references to the licence holder and references to ‘those making representations’ should be read as references to those applying for the review.

9. In the event that the Sub Committee has decided that cross-examination will be permitted, those making representations will be invited to ask questions of the applicant and their witnesses (if any). The applicant and any witnesses giving evidence in support will then answer any questions put to them by members of the Sub Committee.
10. The Chairman will ask all parties if there is anything else they would like to add in support of their respective cases.
11. Those making representations will then be invited to make closing submissions followed by the applicant.
12. The Sub Committee will then retire to consider their decision. They may call for assistance by the representatives of the Town Clerk and/or the Comptroller & City Solicitor but those persons will play no part in the decision-making process.
13. In due course, the Sub Committee will return to announce their decision or to inform those present when the decision will be given.

Committee: Licensing (Hearing) Sub-Committee	Hearing Date: 16 July 2014
Subject: Licensing Act 2003 - Application for a new premises license	
Name of premises: Badolina Address of premises: 210 Bishopsgate, EC2M 4NR	
Report of: Director of Markets and Consumer Protection	Public
Ward (if appropriate): Bishopsgate	

1 Introduction

- 1.1 To consider and determine, by public hearing, the application for a new premises license under the Licensing Act 2003, taking into account the representations of other persons detailed in paragraph 5 and the policy considerations detailed in paragraph 6 of this report.
- 1.2 The decision of the Sub-Committee must be made with a view to promoting one or more of the four licensing objectives, namely:
 - the prevention of crime and disorder
 - public safety
 - the prevention of public nuisance
 - the protection of children from harm

2 Summary of Application

- 2.1 An application made by:

Olive Grill Ltd
220 The Vale
Golders Green
NW11 8SR

was received by the City of London Licensing Authority on 21 May 2014 for a new premises licence in respect of the premises:

Badolina
210 Bishopsgate
EC2M 4NR

2.2 Full details of the application are contained in the copy of the Application Form at Appendix 1.

2.4 The application is to provide the following activities:

<u>Activity</u>	<u>Current Licence</u>	<u>Proposed</u>
Supply of Alcohol	N/A	Mon to Sun 11:00 – 23:00

2.5 The supply of alcohol is for ‘on’ and ‘off’ the premises.

2.6 The Operating Schedule submitted by the applicant suggests a number of steps intended to be taken in order to promote the four licensing objectives. Those conditions which are consistent with the operating schedule and could be included on the licence are attached as Appendix 2.

2.7 The mandatory licence conditions can be found in the Licensing Act 2003, sections 19-21. Also, in the Schedules to The Licensing Act 2003 (Mandatory Licensing Conditions) Order 2010 and The Licensing Act 2003 (Mandatory Conditions) Order 2014.

3 Licensing History of Premises

3.1 The premises is a new license although currently exists as a café/take away selling food and drink.

4 Representations from Responsible Authorities

4.1 There is one representation from the Environmental Health Food Team. The representation is against the granting of the licence on the basis that they have no toilet facilities which could encourage people to

consume alcohol supplied by the premises and urinate outside on the highway. A copy of the representation can be seen as Appendix 3.

5 Representations From Other Persons

- 5.1 Three representations have been received from ‘other persons’. The representations are against the granting of the application on the basis that it would undermine the licensing objective concerning primarily the prevention of public nuisance. Minor references are also made of the possibility of undermining the licensing objective of the prevention of crime and disorder.
- 5.2 Only aspects of the representations that relate to a licensable activity can be considered. All three representations are from the same premises and are made by the General Manager and two Assistant Managers of the Woodin’s Shades. The representations are attached in their entirety at Appendix 4(i) to (iii).

6 Policy Considerations

- 6.1 In carrying out its licensing functions, the Licensing Authority must have regard to its Statement of Licensing policy and statutory guidance issued under s 182 of the Licensing Act 2003.

City of London Corporation’s Statement of Licensing Policy

- 6.2 The following sections/paragraphs of the City of London Corporation’s Statement of Licensing Policy are particularly applicable to this application.

Paragraph 29 states that in completing the operating schedule, applicants should set out in some detail how they intend to run the premises in order to promote the four licensing objectives.

Paragraph 50 states an overriding policy principle namely, that each application will be decided on its individual merits, with the process complying with the regulations made under the Licensing Act 2003.

Paragraphs 51-54 state the Corporation's policy on setting conditions which may be applicable dependant on the step(s) taken by members as stated in paragraph nine of this report.

Paragraph 59 addresses the need to strike a fair balance between the desires and expectations of operators and the benefits to the community of licensed venues with the reasonable expectations of local residents and workers not to be disturbed during night time hours.

Paragraph 66 introduces a number of relevant matters to be considered by the City Corporation when assessing the likelihood of a particular licensable activity causing an unacceptable adverse impact, particularly on local residents and businesses.

Statutory Guidance

- 6.3 The following sections/paragraphs of the statutory guidance issued under s182 of the Licensing Act 2003 are particularly applicable to this application (revised October 2012):

Chapter 2 of the guidance covers the four licensing objectives. In particular, paragraph 2.18 states that it is, '...important that in considering the promotion of [*the public nuisance licensing objective, licensing authorities*] focus on the effect of the licensable activities at the specific premises on persons living and working (including those carrying on business) in the area around the premises which may be disproportionate and unreasonable.' Also, paragraph 2.19 indicates that the prevention of public nuisance could, 'include low-level nuisance perhaps affecting a few people living locally.....'

Chapter 10 refers to conditions attached to premises licences with paragraph 10.10 stating that, 'Conditions should be determined on a case-by-case basis and standard conditions which ignore these individual aspects should be avoided.' Also, 'Licensing authorities should therefore ensure that any conditions they impose are only those which are appropriate for the promotion of the licensing objectives.'

7 Map and Plans

- 7.1 A map showing the location of the premises together with nearby licensed premises is attached at Appendix 5. A key of those premises is included which indicates the maximum permitted hours for alcohol sales in respect of each premises.
- 7.2 A plan of the premises is attached as Appendix 6.

8 Summary

- 8.1 The Licensing Authority has a duty under the Licensing Act 2003 to promote the Licensing Objectives. Each objective has equal importance. In carrying out its licensing functions, the Licensing Authority must also have regard to its Statement of Licensing Policy, any Statutory Guidance under the Licensing Act 2003 and is bound by the Human Rights Act 1998. The Corporation must also fulfil its obligations under section 17 of the Crime and Disorder Act 1998 to do all that it reasonably can to prevent crime and disorder in the City.

9 Options

- 9.1 The Sub-committee must, having regard to the representations, take such of the following steps as it considers appropriate for the promotion of the licensing objectives:
 - i) grant the application subject to any conditions consistent with the operating schedule modified to such extent as the Sub-committee considers appropriate for the promotion of the licensing objectives and include the mandatory conditions contained in Ss. 19-21 of the Licensing Act 2003;
 - ii) exclude from the scope of the licence any of the licensable activities to which the application relates; or
 - iii) reject the application

Any determination by the licensing sub-committee will not have effect until the end of 21 days following notification of the decision to the applicant by the licensing authority or, in the event of an appeal to the Magistrates' Court against the Sub-Committee's decision, the determination of the appeal.

10 Recommendation

10.1 It is therefore RECOMMENDED that your Sub-Committee determine this application for a premises licence in accordance with paragraph 9 of this report.

Prepared by P Davenport
Licensing Manager
peter.davenport@cityoflondon.gov.uk

Background Papers

<u>BACKGROUND PAPER</u>	<u>DEPT</u>	<u>FILE</u>
Corporation of London Statement of Licensing Policy (revised Jan 2013)	MCP	5th Floor Walbrook Wharf
Statutory Guidance – ‘June 2013 Amended Guidance Issued Under Section 182 Of The Licensing Act 2003’		https://www.gov.uk/government/publications/section-182-of-the-licensing-act-2003-amended-guidance

Insert name and address of relevant licensing authority and its reference number (optional)

City of London Licensing Team
 Markets and Consumer Protection
 PO Box 270
 Guildhall, London EC2P 2EJ

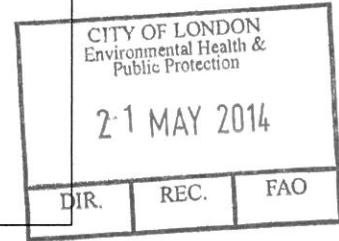

Application for a premises licence to be granted under the Licensing Act 2003

PLEASE READ THE FOLLOWING INSTRUCTIONS FIRST

Before completing this form please read the guidance notes at the end of the form. If you are completing this form by hand please write legibly in block capitals. In all cases ensure that your answers are inside the boxes and written in black ink. Use additional sheets if necessary.

You may wish to keep a copy of the completed form for your records.

XWe Olive Grill Limited
 (Insert name(s) of applicant)

apply for a premises licence under section 17 of the Licensing Act 2003 for the premises described in Part 1 below (the premises) and Xwe are making this application to you as the relevant licensing authority in accordance with section 12 of the Licensing Act 2003

Part 1 - Premises Details

Postal address of premises or, if none, ordnance survey map reference or description Badolina, 210 Bishopsgate	
Post town London	Post code EC2M 4NR
Telephone number at premises (if any)	NOT KNOWN
Non-domestic rateable value of premises	£ 31,750.00

Part 2 - Applicant Details

Please state whether you are applying for a premises licence as

Please tick as appropriate

- | | |
|---|---|
| a) an individual or individuals* | <input type="checkbox"/> please complete section (A) |
| b) a person other than an individual* | |
| i as a limited company | <input checked="" type="checkbox"/> please complete section (B) |
| ii as a partnership | <input type="checkbox"/> please complete section (B) |
| iii as an unincorporated association or | <input type="checkbox"/> please complete section (B) |
| iv other (for example a statutory corporation) | <input type="checkbox"/> please complete section (B) |
| c) a recognised club | <input type="checkbox"/> please complete section (B) |
| d) a charity | <input type="checkbox"/> please complete section (B) |
| e) the proprietor of an educational establishment | <input type="checkbox"/> please complete section (B) |

- f) a health service body please complete section (B)
- g) a person who is registered under Part 2 of the Care Standards Act 2000 (c14) in respect of an independent hospital in Wales please complete section (B)
- ga) a person who is registered under Chapter 2 of Part 1 of the Health and Social Care Act 2008 (within the meaning of that Part) in an independent hospital in England please complete section (B)
- h) the chief officer of police of a police force in England and Wales please complete section (B)

*If you are applying as a person described in (a) or (b) please confirm:

Please tick yes

- I am carrying on or proposing to carry on a business which involves the use of the premises for licensable activities; or
- I am making the application pursuant to a
 - statutory function or
 - a function discharged by virtue of Her Majesty's prerogative

(A) INDIVIDUAL APPLICANTS (fill in as applicable)

Mr <input type="checkbox"/>	Mrs <input type="checkbox"/>	Miss <input type="checkbox"/>	Ms <input type="checkbox"/>	Other Title (for example, Rev)
Surname			First names	
I am 18 years old or over	<input type="checkbox"/>			Please tick yes
Current postal address if different from premises address				
Post town			Post code	
Daytime contact telephone number				
E-mail address (optional)				

SECOND INDIVIDUAL APPLICANT (if applicable)

Mr <input type="checkbox"/>	Mrs <input type="checkbox"/>	Miss <input type="checkbox"/>	Ms <input type="checkbox"/>	Other Title (for example, Rev)
Surname			First names	
I am 18 years old or over	<input type="checkbox"/>			Please tick yes
Current postal address if different from premises address				
Post town			Post code	
Daytime contact telephone number				
E-mail address (optional)				

(B) OTHER APPLICANTS

Please provide name and registered address of applicant in full. Where appropriate please give any registered number. In the case of a partnership or other joint venture (other than a body corporate), please give the name and address of each party concerned.

Name OLIVE GRILL LIMITED
Address [REDACTED] GOLDERS GREEN LONDON [REDACTED]
Registered number (where applicable) 08272848
Description of applicant (for example, partnership, company, unincorporated association etc.) Company
Telephone number (if any)
E-mail address (optional)

Part 3 - Operating Schedule

When do you want the premises licence to start?

DD		MM		YYYY			
a	s	a	p				

If you wish the licence to be valid only for a limited period, when do you want it to end?

DD		MM		YYYY			

If 5,000 or more people are expected to attend the premises at any one time, please state the number expected to attend.

n/a

Please give a general description of the premises (please read guidance note 1)
A restaurant selling food, hot and cold beverages and alcohol.

What licensable activities do you intend to carry on from the premises?
(Please see sections 1 and 14 of the Licensing Act 2003 and Schedules 1 and 2 to the Licensing Act 2003)

Please tick any that apply

Provision of regulated entertainment

- a) plays (if ticking yes, fill in box A)
- b) films (if ticking yes, fill in box B)
- c) indoor sporting events (if ticking yes, fill in box C)
- d) boxing or wrestling entertainment (if ticking yes, fill in box D)
- e) live music (if ticking yes, fill in box E)
- f) recorded music (if ticking yes, fill in box F)
- g) performances of dance (if ticking yes, fill in box G)
- h) anything of a similar description to that falling within (e), (f) or (g) (if ticking yes, fill in box H)

Provision of late night refreshment (if ticking yes, fill in box I)

Supply of alcohol (if ticking yes, fill in box J)

In all cases complete boxes K, L and M

A

Plays Standard days and timings (please read guidance note 6)			Indoors <input type="checkbox"/>	Outdoors <input type="checkbox"/>	Both <input type="checkbox"/>
Day	Start	Finish			
Mon			<u>Please give further details here</u> (please read guidance note 3)		
Tue					
Wed			<u>State any seasonal variations for performing plays</u> (please read guidance note 4)		
Thur					
Fri			<u>Non standard timings. Where you intend to use the premises for the performance of plays at different times to those listed in the column on the left, please list</u> (please read guidance note 5)		
Sat					
Sun					

B

Films Standard days and timings (please read guidance note 6)			Indoors <input type="checkbox"/>	Outdoors <input type="checkbox"/>	Both <input type="checkbox"/>
Day	Start	Finish			
Mon			<u>Please give further details here</u> (please read guidance note 3)		
Tue					
Wed			<u>State any seasonal variations for the exhibition of films</u> (please read guidance note 4)		
Thur					
Fri			<u>Non standard timings. Where you intend to use the premises for the exhibition of films at different times to those listed in the column on the left, please list</u> (please read guidance note 5)		
Sat					
Sun					

C

Indoor sporting events Standard days and timings (please read guidance note 6)			<u>Please give further details</u> (please read guidance note 3)
Day	Start	Finish	
Mon			<u>State any seasonal variations for indoor sporting events</u> (please read guidance note 4)
Tue			
Wed			
Thur			<u>Non standard timings. Where you intend to use the premises for indoor sporting events at different times to those listed in the column on the left, please list</u> (please read guidance note 5)
Fri			
Sat			
Sun			

D

Boxing or wrestling entertainments Standard days and timings (please read guidance note 6)			<u>Will the boxing or wrestling entertainment take place indoors or outdoors or both - please tick</u> (please read guidance note 2)	Indoors	<input type="checkbox"/>
Day	Start	Finish		Outdoors	<input type="checkbox"/>
Mon			Both	<input type="checkbox"/>	<u>Please give further details here</u> (please read guidance note 3)
Tue					
Wed			<u>State any seasonal variations for boxing or wrestling entertainment</u> (please read guidance note 4)		
Thur			<u>Non standard timings. Where you intend to use the premises for boxing or wrestling entertainment at different times to those listed in the column on the left, please list</u> (please read guidance note 5)		
Fri					
Sat					
Sun					

E

Live music Standard days and timings (please read guidance note 6)			<u>Will the performance of live music take place indoors or outdoors or both - please tick</u> (please read guidance note 2)	Indoors	<input type="checkbox"/>
Day	Start	Finish		Outdoors	<input type="checkbox"/>
Mon			<u>Please give further details here</u> (please read guidance note 3)	Both	<input type="checkbox"/>
Tue					
Wed				<u>State any seasonal variations for the performance of live music</u> (please read guidance note 4)	
Thur					
Fri				<u>Non standard timings. Where you intend to use the premises for the performance of live music at different times to those listed in the column on the left, please list</u> (please read guidance note 5)	
Sat					
Sun					

F

Recorded music Standard days and timings (please read guidance note 6)			<u>Will the playing of recorded music take place indoors or outdoors or both - please tick</u> (please read guidance note 2)	Indoors	<input type="checkbox"/>
Day	Start	Finish		Outdoors	<input type="checkbox"/>
Mon			<u>Please give further details here</u> (please read guidance note 3)	Both	<input type="checkbox"/>
Tue					
Wed				<u>State any seasonal variations for the playing of recorded music</u> (please read guidance note 4)	
Thur					
Fri				<u>Non standard timings. Where you intend to use the premises for the playing of recorded music at different times to those listed in the column on the left, please list</u> (please read guidance note 5)	
Sat					
Sun					

G

Performances of dance Standard days and timings (please read guidance note 6)			<u>Will the performance of dance take place indoors or outdoors or both - please tick</u> (please read guidance note 2)	Indoors	<input type="checkbox"/>
Day	Start	Finish		Outdoors	<input type="checkbox"/>
Mon				Both	<input type="checkbox"/>
Tue				<u>Please give further details here</u> (please read guidance note 3)	
Wed				<u>State any seasonal variations for the performance of dance</u> (please read guidance note 4)	
Thur					
Fri				<u>Non standard timings. Where you intend to use the premises for the performance of dance at different times to those listed in the column on the left, please list</u> (please read guidance note 5)	
Sat					
Sun					

H

Anything of a similar description to that falling within (e), (f) or (g) Standard days and timings (please read guidance note 6)			<u>Please give a description of the type of entertainment you will be providing</u>		
Day	Start	Finish	<u>Will this entertainment take place indoors or outdoors or both - please tick</u> (please read guidance note 2)	Indoors	<input type="checkbox"/>
Mon					Outdoors
Tue			Both		<input type="checkbox"/>
Wed			<u>Please give further details here</u> (please read guidance note 3)		
Thur				<u>State any seasonal variations for entertainment of a similar description to that falling within (e), (f) or (g)</u> (please read guidance note 4)	
Fri					
Sat				<u>Non standard timings. Where you intend to use the premises for the entertainment of a similar description to that falling within (e), (f) or (g) at different times to those listed in the column on the left, please list</u> (please read guidance note 5)	
Sun					

I

Late night refreshment Standard days and timings (please read guidance note 6)			<u>Will the provision of late night refreshment take place indoors or outdoors or both - please tick</u> (please read guidance note 2)	Indoors	<input type="checkbox"/>
				Outdoors	<input type="checkbox"/>
Day	Start	Finish	Both <input type="checkbox"/>		
Mon			<u>Please give further details here</u> (please read guidance note 3)		
Tue					
Wed			<u>State any seasonal variations for the provision of late night refreshment</u> (please read guidance note 4)		
Thur					
Fri			<u>Non standard timings. Where you intend to use the premises for the provision of late night refreshment at different times, to those listed in the column on the left, please list</u> (please read guidance note 5)		
Sat					
Sun					

J

Supply of alcohol Standard days and timings (please read guidance note 6)			<u>Will the supply of alcohol be for consumption - please tick</u> (please read guidance note 7)	On the premises	<input type="checkbox"/>
				Off the premises	<input type="checkbox"/>
Day	Start	Finish	Both <input checked="" type="checkbox"/>		
Mon	11.00	23.00	<u>State any seasonal variations for the supply of alcohol</u> (please read guidance note 4)		
Tue	11.00	23.00			
Wed	11.00	23.00	<u>Non standard timings. Where you intend to use the premises for the supply of alcohol at different times to those listed in the column on the left, please list</u> (please read guidance note 5)		
Thur	11.00	23.00			
Fri	11.00	23.00			
Sat	11.00	23.00			
Sun	11.00	23.00			

State the name and details of the individual whom you wish to specify on the licence as designated premises supervisor:

Name Manuel Alfonsin	
Address [REDACTED] London	
Post code	[REDACTED]
Personal licence number (if known) tbc	
Issuing licensing authority (if known) tbc	

K

Please highlight any adult entertainment or services, activities, other entertainment or matters ancillary to the use of the premises that may give rise to concern in respect of children (please read guidance note 8).

No activities give rise to concern in respect of children.

L

Hours premises are open to the public Standard days and timings (please read guidance note 6)			<u>State any seasonal variations</u> (please read guidance note 4)
Day	Start	Finish	
Mon	10:00	23.00	Non standard timings. Where you intend the premises to be open to the public at different times to those listed in the column on the left, please list (please read guidance note 5)
Tue	10:00	23.00	
Wed	10.00	23.00	
Thur	10.00	23.00	
Fri	10.00	23.00	
Sat	10.00	23.00	
Sun	10.00	23.00	

M - Describe the steps you intend to take to promote the four licensing objectives:**a) General - all four licensing objectives (b, c, d and e)** (please read guidance note 9)

Please see Annex A

b) The prevention of crime and disorder

Please see Annex A

c) Public safety

Please see Annex A

d) The prevention of public nuisance

Please see Annex A

e) The protection of children from harm

Please see Annex A

Checklist:

Please tick to indicate agreement

- I have made or enclosed payment of the fee.
- I have enclosed the plan of the premises.
- I have sent copies of this application and the plan to responsible authorities and others where applicable.
- I have enclosed the consent form completed by the individual I wish to be designated premises supervisor, if applicable.
- I understand that I must now advertise my application.
- I understand that if I do not comply with the above requirements my application will be rejected.

IT IS AN OFFENCE, LIABLE ON SUMMARY CONVICTION TO A FINE NOT EXCEEDING LEVEL 5 ON THE STANDARD SCALE, UNDER SECTION 158 OF THE LICENSING ACT 2003, TO MAKE A FALSE STATEMENT IN OR IN CONNECTION WITH THIS APPLICATION.

Part 4 - Signatures (please read guidance note 10)

Signature of applicant or applicant's solicitor or other duly authorised agent (see guidance note 11). If signing on behalf of the applicant, please state in what capacity.

Signature	[REDACTED]
Date	20 May 2014
Capacity	Joelson Wilson LLP Solicitors and duly authorised agents on behalf of the Applicant

For joint applications, signature of 2nd applicant or 2nd applicant's solicitor or other authorised agent (please read guidance note 12). If signing on behalf of the applicant, please state in what capacity.

Signature	
Date	
Capacity	
Contact name (where not previously given) and postal address for correspondence associated with this application (please read guidance note 13) Corinne Holloway Joelson Wilson LLP [REDACTED]	
Post town London	Post code [REDACTED]
Telephone number (if any)	[REDACTED]
If you would prefer us to correspond with you by e-mail, your e-mail address (optional) [REDACTED]	

Notes for Guidance

1. Describe the premises, for example the type of premises, its general situation and layout and any other information which could be relevant to the licensing objectives. Where your application includes off-supplies of alcohol and you intend to provide a place for consumption of these off-supplies, you must include a description of where the place will be and its proximity to the premises.
2. Where taking place in a building or other structure please tick as appropriate (indoors may include a tent).
3. For example the type of activity to be authorised, if not already stated, and give relevant further details, for example (but not exclusively) whether or not music will be amplified or unamplified.
4. For example (but not exclusively), where the activity will occur on additional days during the summer months.
5. For example (but not exclusively), where you wish the activity to go on longer on a particular day e.g. Christmas Eve.
6. Please give timings in 24 hour clock (e.g. 16:00) and only give details for the days of the week when you intend the premises to be used for the activity.
7. If you wish people to be able to consume alcohol on the premises, please tick 'on the premises'. If you wish people to be able to purchase alcohol to consume away from the premises, please tick 'off the premises'. If you wish people to be able to do both, please tick 'both'.
8. Please give information about anything intended to occur at the premises or ancillary to the use of the premises which may give rise to concern in respect of children, regardless of whether you intend children to have access to the premises, for example (but not exclusively) nudity or semi-nudity, films for restricted age groups or the presence of gaming machines.
9. Please list here steps you will take to promote all four licensing objectives together.
10. The application form must be signed.
11. An applicant's agent (for example solicitor) may sign the form on their behalf provided that they have actual authority to do so.
12. Where there is more than one applicant, each of the applicant or their respective agent must sign the application form.
13. This is the address which we shall use to correspond with you about this application.

ANNEX A

1. The supply of alcohol at the premises shall only be to a person taking a meal there and for consumption by such a person as ancillary to their meal.
2. A direct telephone number for members of management at the premises shall be made available to local residents associations and to any person wishing to comment on the operation of the premises.
3. CCTV must be installed at the premises. Tapes and visual images recorded shall be retained for a period of 31 days and the system installed at the premises must be at least in accordance with the specification issued by the Licensing Authority. Access to the system must be made available to an Authorised Officer on request.
4. All sales of alcohol for consumption off the premises shall be in sealed containers only.
5. Notices shall be prominently displayed at all exits requesting patrons to respect the needs of local residents and leave the area quietly.
6. Substantial food and non-intoxicating beverages, including drinking water, shall be available in all parts of the premises where alcohol is sold or supplied for consumption on the premises.
7. A proof of age scheme, such as Challenge 21, shall be operated at the premises where the only acceptable forms of identification are recognised photographic identification cards, such as a driving licence or passport.
8. An incident log shall be kept at the premises, and made available on request to an authorised officer of the Council or the Police, which will record the following:
 - (a) all crimes reported to the venue;
 - (b) all ejections of patrons;
 - (c) any complaints received;
 - (d) any incidents of disorder;
 - (e) seizures of drugs or offensive weapons;
 - (f) any faults in the CCTV system or searching equipment or scanning equipment
 - (g) any refusal of the sale of alcohol; or
 - (h) any visit by a relevant authority or emergency service.
9. No noise shall emanate from the premises nor vibration be transmitted through the structure of the premises which gives rise to a nuisance.

This page is intentionally left blank

Badolina – 210 Bishopsgate
Conditions Consistent with the Operating Schedule

1. There shall be no sale of alcohol in unsealed containers for consumption off the premises (MC17)
2. The supply of alcohol at the premises shall only be to a person seated taking a table meal and for the consumption by such a person as ancillary to their meal (MC27)
3. An incident log shall be kept at the premises and made available on request to the Police or an authorised officer of the City of London Corporation. The log will record the following:
 - (a) all ejections of patrons
 - (b) any incidents of disorder (disturbance caused by one or more persons)
 - (c) any refusal of the sale of alcohol

This page is intentionally left blank

Aznar, Stephen

From: Cowland, Debra
Sent: 13 June 2014 15:01
To: Aznar, Stephen
Cc: Cowland, Debra
Subject: Badalona 210 Bishopsgate WORKSHEET 201406373

Stephen, as discussed. I would object to the licence application as there is an intention to allow customers in the small seating area to consume alcohol. As there is no W.C. and currently the staff use the toilet across the road (Woodin n' shades). I feel this could be detrimental to the area as it would or could encourage people to urinate publically outside.

Regards
Debra Cowland

Chartered Environmental Health Practitioner
Dept. of Markets and Consumer Protection



This page is intentionally left blank

- 6 JUN 2014

DIR. REC. FAO

City of London Licensing Authority,
Walbrook Wharf,
78-83 Upper Thames Street,
London,
EC4R 3TD

To the City of London Licensing Authority,

As Manager of the Woodin's Shade, 212 Bishops Gate, I hereby object to the application of Olive Grill Limited for the sale of alcohol at Badolina, 210 Bishopsgate, between the hours of 11.00 – 23.00 on the basis of potential to cause a public disturbance.

As a long established public house in the area, we are aware of a severe problem with vagrant and homeless persons in the area. I believe that the sale of packaged alcohol on this premises will further exacerbate the problem, by providing yet another opportunity for these persons to purchase alcohol, as there is not entry policy, security controls, or dress code. Furthermore, the outdoor seating provided by Badolina, specifically tables in Middlesex street, creates an opportunity for these persons to steal open containers that are not finished, which will lead to civil disorder and incidences of drunken behaviour to increase in Middlesex street and Bishopsgate.

In addition to this, the sale of packaged alcohol provides a security risk to our guests, by providing a point of sale for alcohol in close proximity to a business that holds the right to refuse service to any person we deem unfit to consume alcohol or remain in the premises. The ability to walk just 15 metres to purchase more alcohol allows for individuals that have been ejected or refused service for any offences, including violence, drunken behaviour or drug use, to then continue to cause problems to our business, customers and passing members of the public. The pubs in the area already work to eradicate this problem by jointly refusing service to these persons. A premises that does not have a similar priority may not comply, creating a security risk.

Furthermore, despite rigorous controls in our business to prevent the consumption of packaged alcohol that has not been purchased on site, a new source of packaged alcohol severely increases the risk of this occurring and also further limits our ability to control the situation. It would be possible for members of the public to purchase a single drink in our premises, keep the glass, and continue to top it up with alcohol purchased at Badolina, creating a situation where neither premises has control over the amount of alcohol members of the public are consuming. This is dangerous to public health and also puts our premises licence at risk.

Finally, I believe that Badolina is not in any need of a licence to serve alcohol. It will not influence their primary source of income, their food. As a minimal addition to their income, it will create far more problems than the potential revenue it could generate.

I sincerely hope that you will consider these objections carefully, and make the decision which best protects the public of Bishopsgate.

Sincerely,
Adele Nakchbandi
General Manager of the Woodin's Shades.
212 Bishopsgate
EC2M 4PT

This page is intentionally left blank

City of London Licensing Authority,
Walbrook Wharf,
78-83 Upper Thames Street,
London,
EC4R 3TD

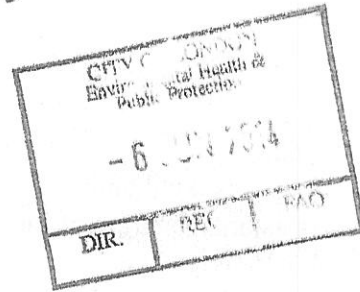

To the City of London Licensing Authority,

As Assistant Manager of the Woodin's Shade, 212 Bishops Gate, I hereby object to the application of Olive Grill Limited for the sale of alcohol at Badolina, 210 Bishopsgate, between the hours of 11.00 – 23.00 on the basis of potential to cause a public disturbance.

As a long established public house in the area, we are aware of a severe problem with vagrant and homeless persons in the area. I believe that the sale of packaged alcohol on this premises will further exacerbate the problem, by providing yet another opportunity for these persons to purchase alcohol, as there is not entry policy, security controls, or dress code. Furthermore, the outdoor seating provided by Badolina, specifically tables in Middlesex street, creates an opportunity for these persons to steal open containers that are not finished, which will lead to civil disorder and incidences of drunken behaviour to increase in Middlesex street and Bishopsgate.

In addition to this, the sale of packaged alcohol provides a security to risk to our guests, by providing a point of sale for alcohol in close proximity to a business that holds the right to refuse service to any person we deem unfit to consume alcohol or remain in the premises. The ability to walk just 15 metres to purchase more alcohol allows for individuals that have been ejected or refused service for any offences, including violence, drunken behaviour or drug use, to then continue to cause problems to our business, customers and passing members of the public. The pubs in the area already work to eradicate this problem by jointly refusing service to these persons. A premises that does not have a similar priority may not comply, creating a security risk.

Furthermore, despite rigorous controls in our business to prevent the consumption of packaged alcohol that has not been purchased on site, a new source of packaged alcohol severely increases the risk of this occurring and also further limits our ability to control the situation. It would be possible for members of the public to purchase a single drink in our premises, keep the glass, and continue to top it up with alcohol purchased at Badolina, creating a situation where neither premises has control over the amount of alcohol members of the public are consuming. This is dangerous to public health and also puts our premises licence at risk.

I would also like to raise my concerns as a parent of Bishopsgate. The levels of homeless and intoxicated persons occupying Bishopsgate is already at a high level. Another point of sale for alcohol will further increase the risk to my daughters safety as she travels to and from our home at night and during the day. I am aware that she is already intimidated by these journeys and the idea that the risk could increase severely worries me. Any further stress on her or my own part is absolutely unnecessary and unacceptable.

Finally, I believe that Badolina is not in any need of a licence to serve alcohol. It will not influence their primary source of income, their food. As a minimal addition to their income, it will create far more problems than the potential revenue it could generate.

I sincerely hope that you will consider these objections carefully, and make the decision which best protects the public of Bishopsgate.

Sincerely,
Norma Nakchbandi
Assistant Manager of the Woodin's Shades.
212 Bishopsgate
EC2M 4PT

City of London Licensing Authority,
Walbrook Wharf,
78-83 Upper Thames Street,
London,
EC4R 3TD



To the City of London Licensing Authority,

As Assistant Manager of the Woodin's Shade, 212 Bishops Gate, I hereby object to the application of Olive Grill Limited for the sale of alcohol at Badolina, 210 Bishops gate, between the hours of 11.00 – 23.00 on the basis of potential to cause a public disturbance.

As a long established public house in the area, we are aware of a severe problem with vagrant and homeless persons in the area. I believe that the sale of packaged alcohol on this premises will further exacerbate the problem, by providing yet another opportunity for these persons to purchase alcohol, as there is not entry policy, security controls, or dress code. Furthermore, the outdoor seating provided by Badolina, specifically tables in Middlesex street, creates an opportunity for these persons to steal open containers that are not finished, which will lead to civil disorder and incidences of drunken behaviour to increase in Middlesex street and Bishops Gate.

In addition to this, the sale of packaged alcohol provides a security to risk to our guests, by providing a point of sale for alcohol in close proximity to a business that holds the right to refuse service to any person we deem unfit to consume alcohol or remain in the premises. The ability to walk just 15 metres to purchase more alcohol allows for individuals that have been ejected or refused service for any offences, including violence, drunken behaviour or drug use, to then continue to cause problems to our business, customers and passing members of the public. The pubs in the area already work to eradicate this problem by jointly refusing service to these persons. A premises that does not have a similar priority may not comply, creating a security risk.

Furthermore, despite rigorous controls in our business to prevent the consumption of packaged alcohol that has not been purchased on site, a new source of packaged alcohol severely increases the risk of this occurring and also further limits our ability to control the situation. It would be possible for members of the public to purchase a single drink in our premises, keep the glass, and continue to top it up with alcohol purchased at Badolina, creating a situation where neither premises has control over the amount of alcohol members of the public are consuming. This is dangerous to public health and also puts our premises licence at risk.

Finally, I believe that Badolina is not in any need of a licence to serve alcohol. It will not influence their primary source of income, their food. As a minimal addition to their income, it will create far more problems than the potential revenue it could generate.

I sincerely hope that you will consider these objections carefully, and make the decision which best protects the public of Bishops gate.

Sincerely,
Daniel Bell
Assistant Manager of the Woodin's Shades.



This page is intentionally left blank

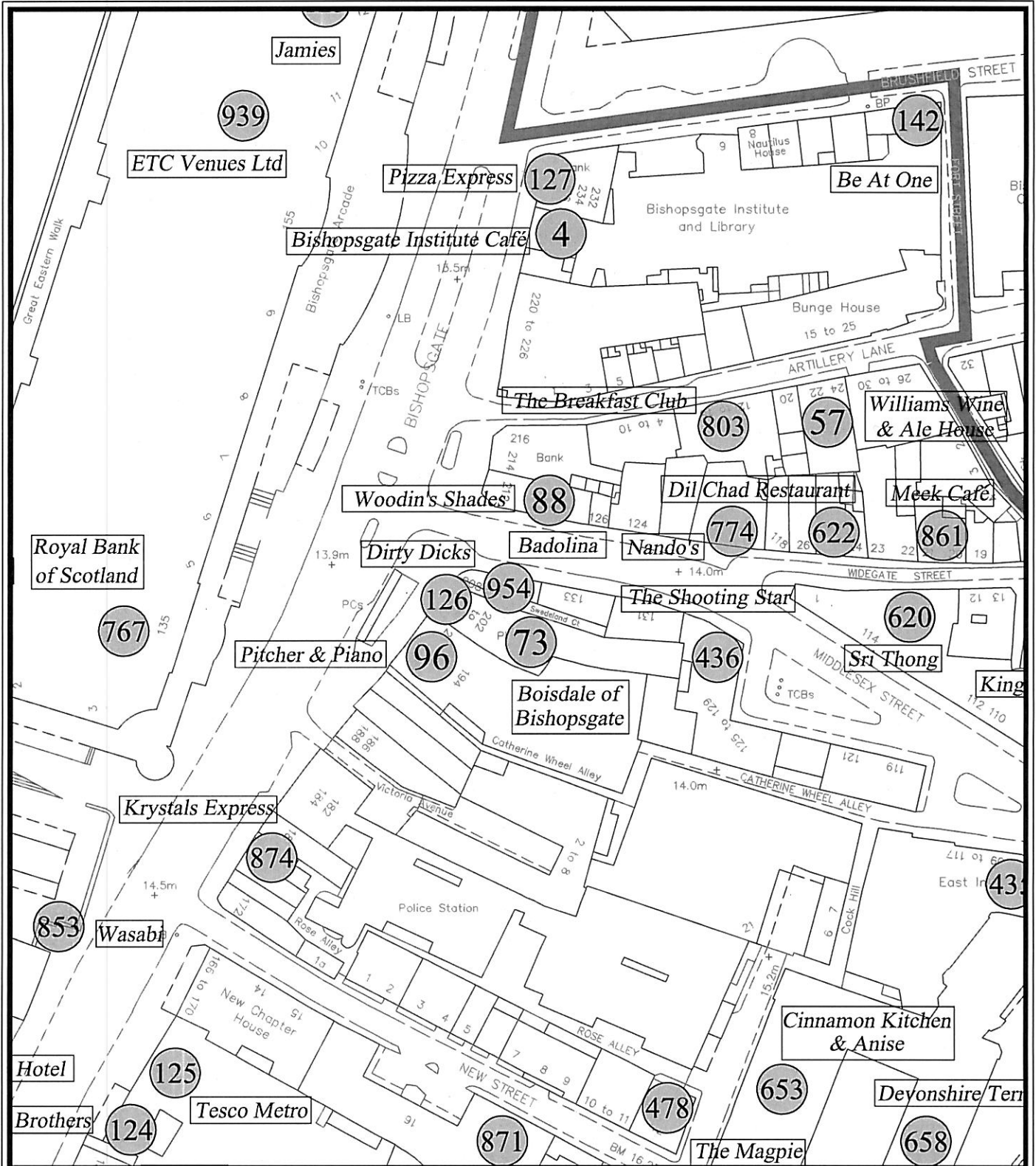

Address :

Badolina (ref 954),
210 Bishopsgate,
London, EC2M 4NR.

PLAN PREPARED BY THE CARTOGRAPHIC
CAD & RESEARCH SECTION OF THE
CONSTRUCTION PROJECTS DIVISION
P.G.Bennett, MA (Cantab) FRICS
City Surveyor

CITY SURVEYOR'S DEPARTMENT
Tel : 020 7332 1507



**MARKETS AND CONSUMER
PROTECTION**
*Environmental Health and Public Protection
Section*

PO BOX 270, GUILDHALL,
LONDON, EC2P 2EJ.
Tel : 020 7332 3227 Fax : 020 7332 3536

Print Scale :
1 : 1 @ A3

Date : Jun 2014

Drawn by :
M.J.B.

Drawing No :

5-C-38173

Based upon the Ordnance Survey mapping with the permission of
the Controller of Her Majesty's Stationery Office © Crown
Copyright. Unauthorised reproduction infringes Crown copyright
and may lead to prosecution or civil proceedings.
City of London 100023243 2012

Scale 1:750



Badolina, 210 Bishopsgate, London, EC2M 4NR

<u>Map Reference</u> <u>Maximum Permitted Hours</u>	<u>Name</u>	<u>Maximum Permitted Hours</u> <u>for Alcohol Sales</u>
1. (124)	Balls Brothers	Sun - Sat: 07:00 – 01:00
2. (125)	Tesco Metro	Sun - Sat: 23:00 – 00:00
3. (478)	The Magpie	Thu – Sat: 10:00 – 01:00
4. (653)	Cinammon Kitchen	Sun - Sat: 09:00 – 03:00
5. (658)	Devonshire Terrace	Sun – Sat: 07:00 – 03:00
6. (435)	Lanes	Thu - Sat: 10:00 – 02:00
7. (853)	Wasabi	No Alcohol Sales
8. (874)	Krystals Express	Sun - Sat: 00:01 – 00:00
9. (767)	RBOS	Sun - Sat: 07:00 – 00:00
10. (96)	Pitcher & Piano	Sun - Sat: 11:00 – 02:00
11. (73)	Boisdale of Bishopsgate	Mon – Sat: 10:00 – 23:00
12. (436)	Shooting Star	Sat: 10:00 – 02:00
13. (620)	Sri Thong	Mon – Sat: 10:00 – 00:00
14. (126)	Dirty Dicks	Fri – Sat: 08:00 – 01:00
15. (774)	Nandos	Sun – Sat: 11:00 – 00:00
16. (622)	Dil Chad	Mon – Sat: 10:00 – 00:00
17. (861)	Meek Café	Sun – Sat: 10:00 – 23:00
18. (88)	Woodin Shades	Thu – Sat: 10:00 – 01:00
19. (803)	The Breakfast Club	Mon – Sat: 07:00 – 00:00
20. (57)	Williams Wine & Ale House	Mon – Sat: 10:00 – 23:00
21. (4)	Bishopsgate Institute	Sun – Sat: 11:00 – 23:30
22. (127)	Pizza Express	Mon – Sat: 10:00 – 23:00
23. (939)	Etc Venues	Sun – Sat: 08:00 – 23:00
24. (142)	Be At One	Sun – Sat: 08:00 – 01:00
25. (123)	Jamies	Sun – Sat: 07:00 – 02:00

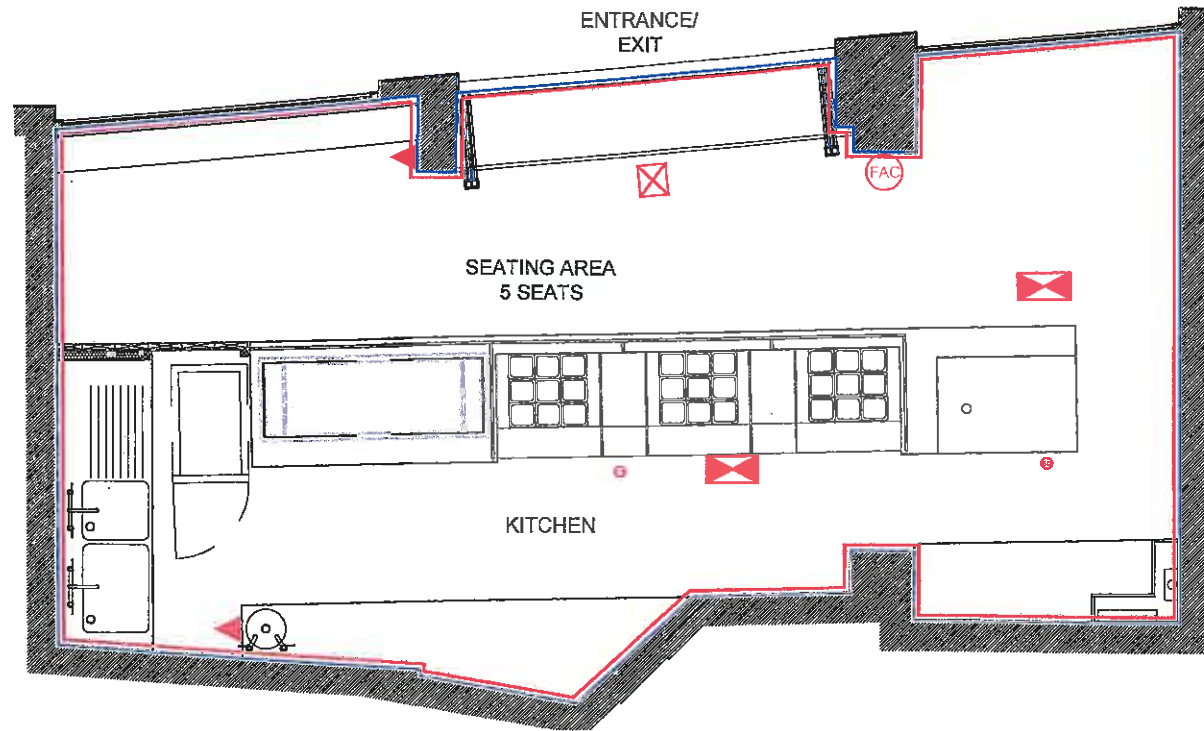

PROPOSED GROUND FLOOR PLAN
SCALE 1:50

NOTE
The position of fire and safety equipment as shown on the plan or such other position as agreed from time to time in consultation with the fire authority

KEY:	
Denotes area to be used for licensable activities	Site Boundary Extents
FIRE ALARM BREAK GLASS to be provided adjacent to final exits	EMERGENCY LIGHT
SMOKE DETECTOR	FIRE ALARM CONTROL PANEL
FIRE EXTINGUISHER	FIRE EXIT SIGN approved sounders to mains as per fire officers approval



REV	DATE	NOTES
1	15.05.14	First Issue

INT	Project title	Scale @ A3
MG	Badolina, 206-210 Bishopsgate	1:50
	Drawing title	Drawn
	Proposed Ground Floor- Licensing Plan	MG
	Drawing no.	Checked
	14018_GA_001	BM

This page is intentionally left blank